

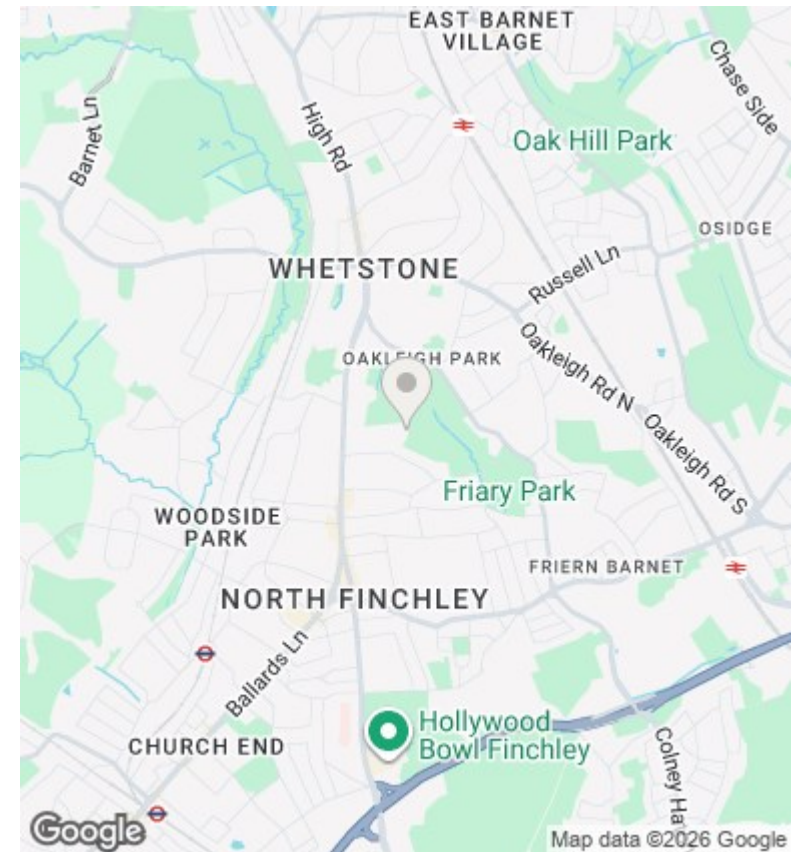

Finchley Park, London, N12 9JR

£1,500 Per Calendar Month

- Recently redecorated one-bedroom ground floor purpose-built apartment
- Private paved front garden
- Fitted kitchen with appliances
- Available NOW
- Located in a quiet residential turning
- Close to local shops, cafés, restaurants and everyday amenities
- Council tax band B
- Bright and spacious reception room
- Convenient for Woodside Park Underground Station (Northern Line)
- Part - Furnished

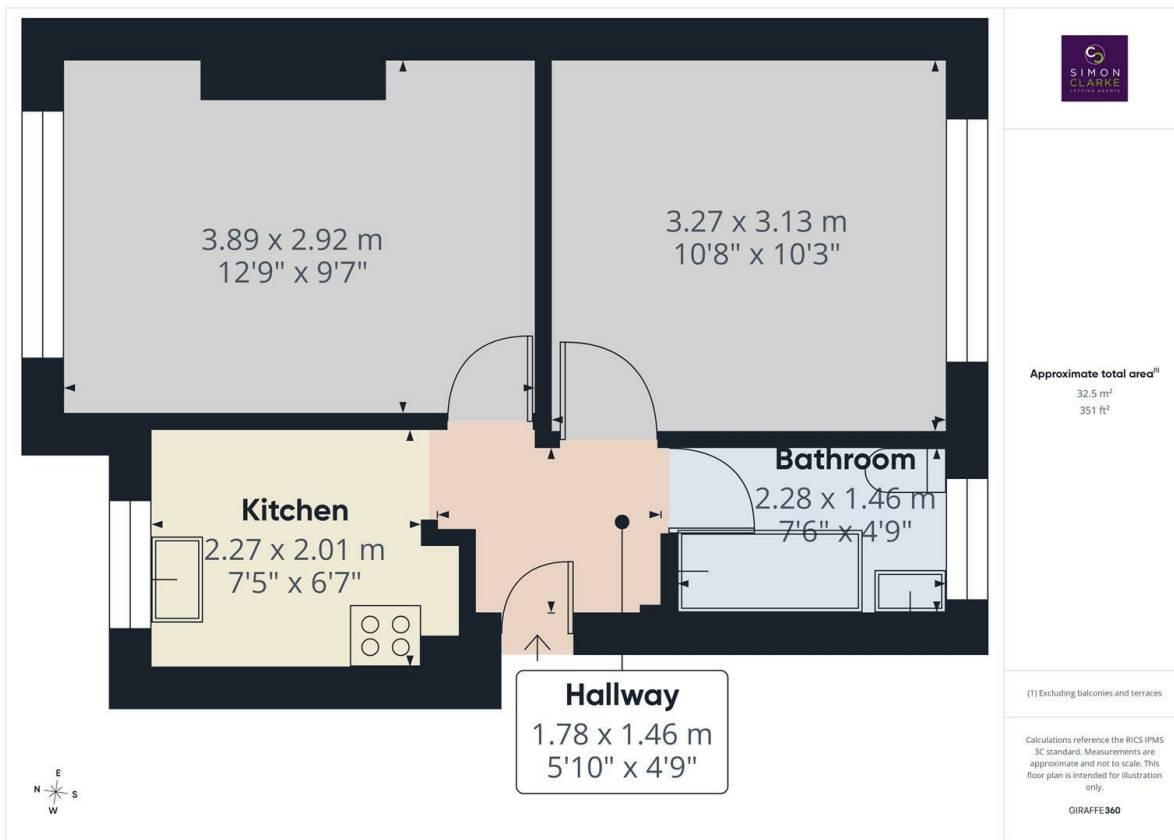

## Directions

## Viewings

Viewings by arrangement only. Call 02083499000 to make an appointment.

## Council Tax Band

B

## EPC Rating:

Energy Efficiency Rating		
	Current	Potential
<i>Very energy efficient - lower running costs</i>		
(92 plus) <b>A</b>		
(81-91) <b>B</b>		
(69-80) <b>C</b>		
(55-68) <b>D</b>		
(39-54) <b>E</b>		
(21-38) <b>F</b>		
(1-20) <b>G</b>		
<i>Not energy efficient - higher running costs</i>		
<b>England &amp; Wales</b>	EU Directive 2002/91/EC	