

25 Hartham Road, London, N7 9JQ

£2,000 PCM

- Located on Hartham Road in the sought-after Hillmarton Conservation Area, Islington
- Charming 1-bedroom apartment set within a beautifully converted period building
- Raised ground floor apartment
- Bright and spacious reception room
- Well-proportioned double bedroom with plenty of natural light
- Fully equipped kitchen with appliances including dishwasher
- Newly decorated throughout
- Unfurnished
- Council tax band D
- Available NOW

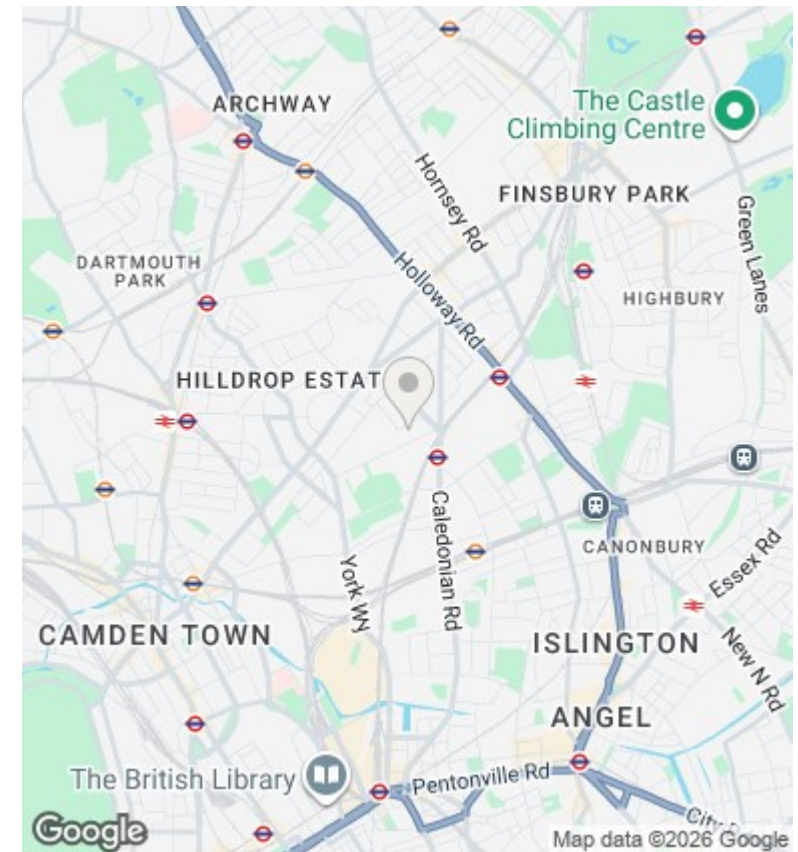
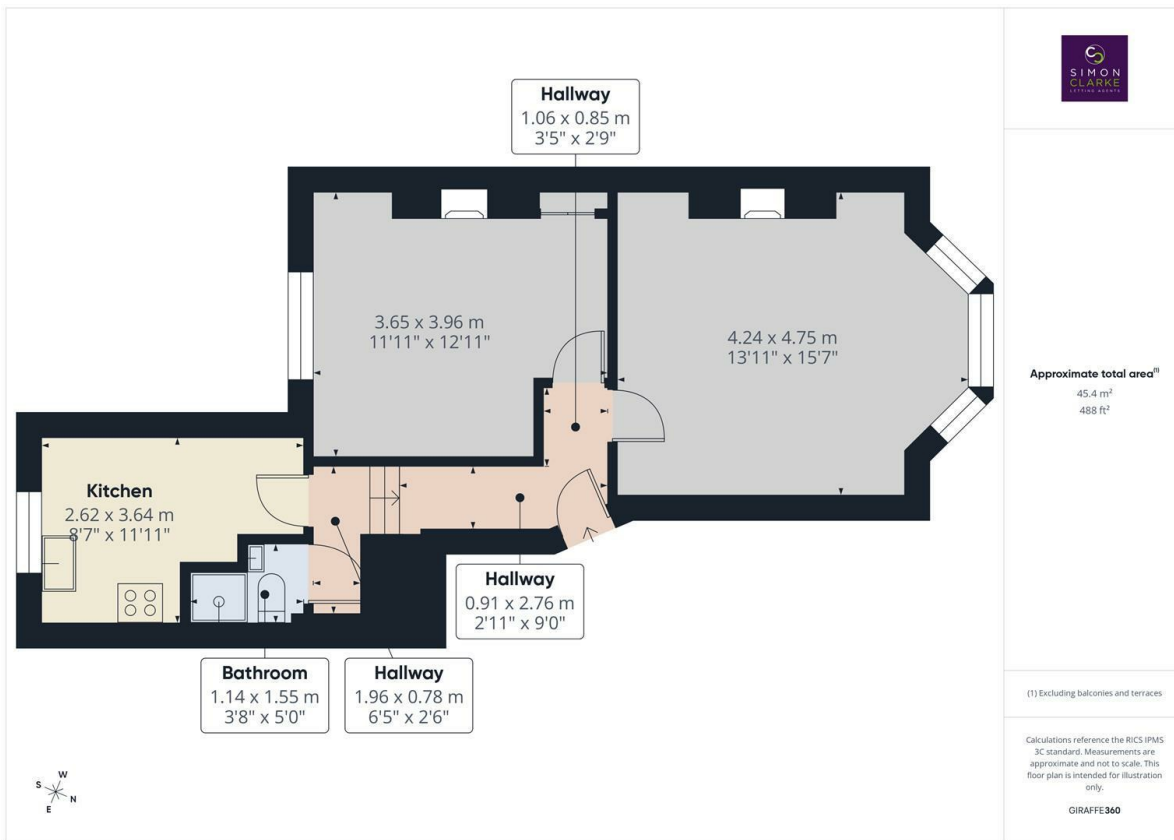

## Directions

## Viewings

Viewings by arrangement only. Call 02083499000 to make an appointment.

## Council Tax Band

D

## EPC Rating:

D

