

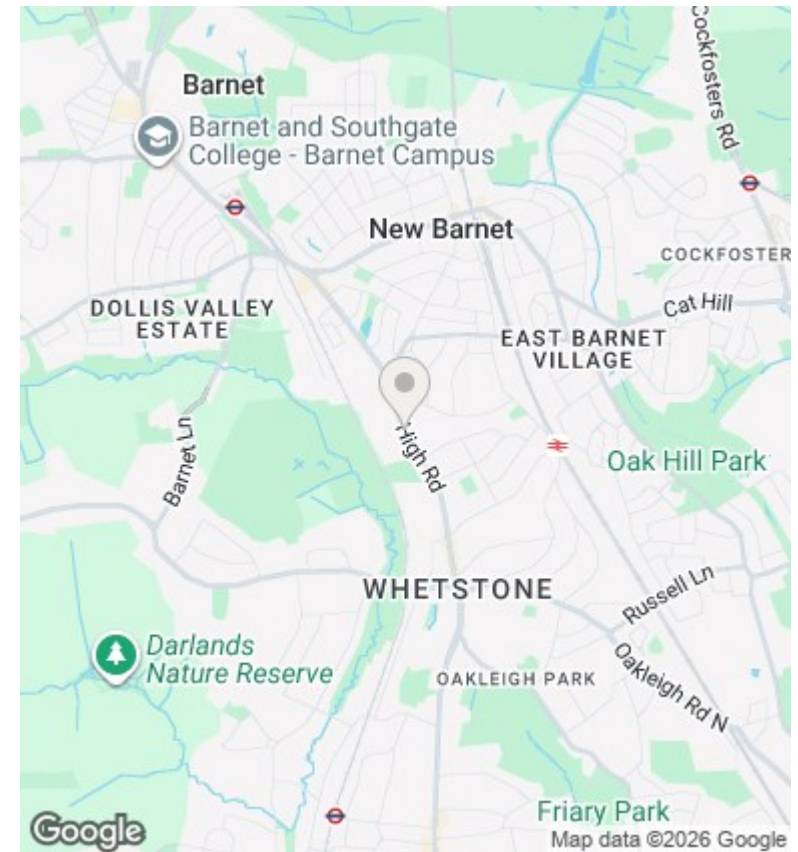

High Road, London, N20 9PJ

£2,100 Per Month

- Managed by Simon Clarke Letting Agents
- Underfloor heating throughout
- Available on long term tenancy (initial 12 months)
- Available from 23rd July 2026
- First floor 2 bedroom apartment
- Stunning bathroom suite
- Council tax Band C
- Juliet style balcony off lounge
- Open plan kitchen with the lounge
- Unfurnished

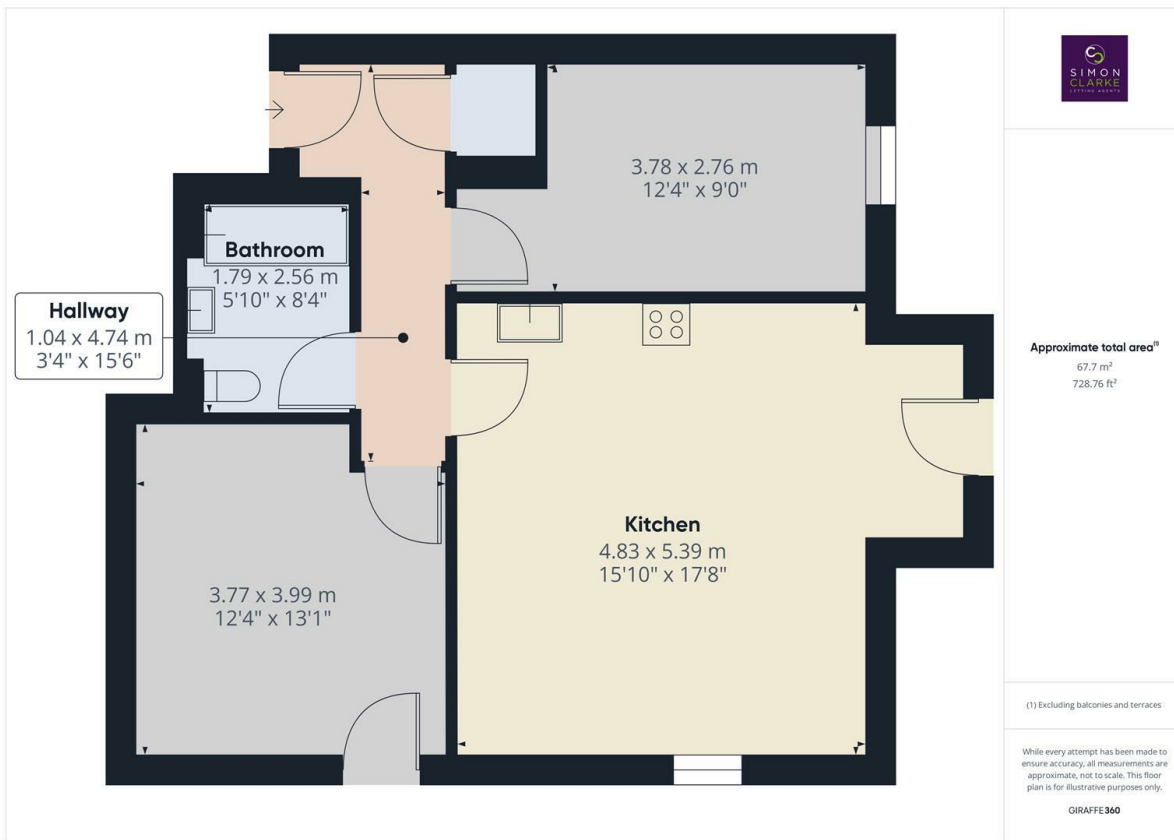

Directions

Viewings

Viewings by arrangement only. Call 02083499000 to make an appointment.

Council Tax Band

C

EPC Rating:

Energy Efficiency Rating		
	Current	Potential
<i>Very energy efficient - lower running costs</i>		
(92 plus) A		
(81-91) B		
(69-80) C		
(55-68) D		
(39-54) E		
(21-38) F		
(1-20) G		
<i>Not energy efficient - higher running costs</i>		
England & Wales	EU Directive 2002/91/EC	