

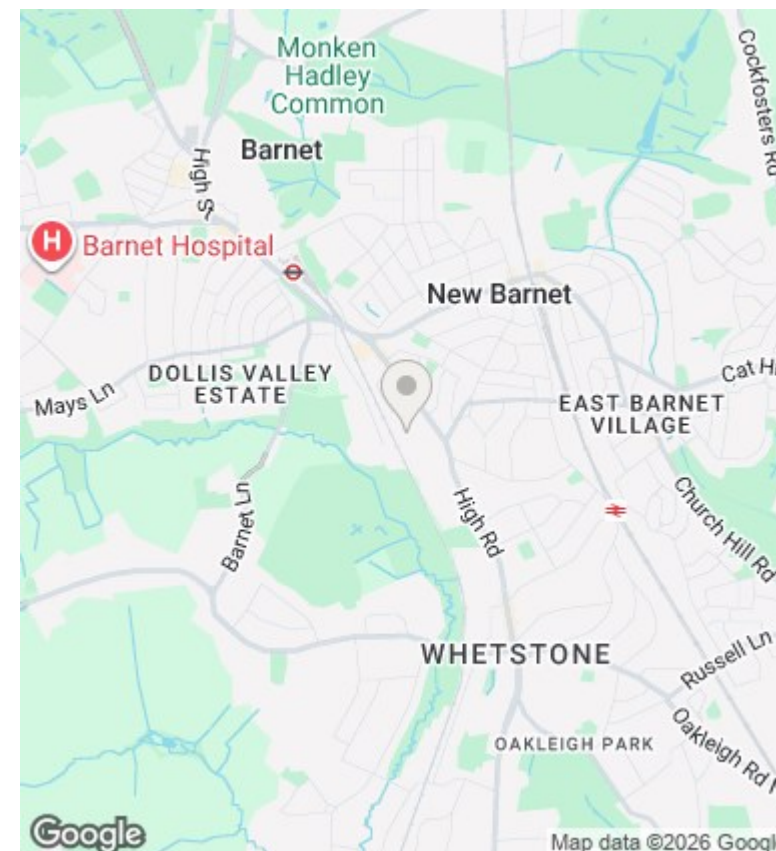

Hillier Close, London, EN5 1BE

£2,100 PCM

- Managed by Simon Clarke Letting Agents
- Modern fitted kitchen with appliances
- Council tax band D
- Deposit: £2,420 (Equivalent to 5 weeks rent)
- 3 Bedroom Mid Terraced House
- Low maintenance garden
- Available from 21st February 2026
- Off street parking for 2 cars
- Available on long term tenancy (initial 12 months)
- Unfurnished

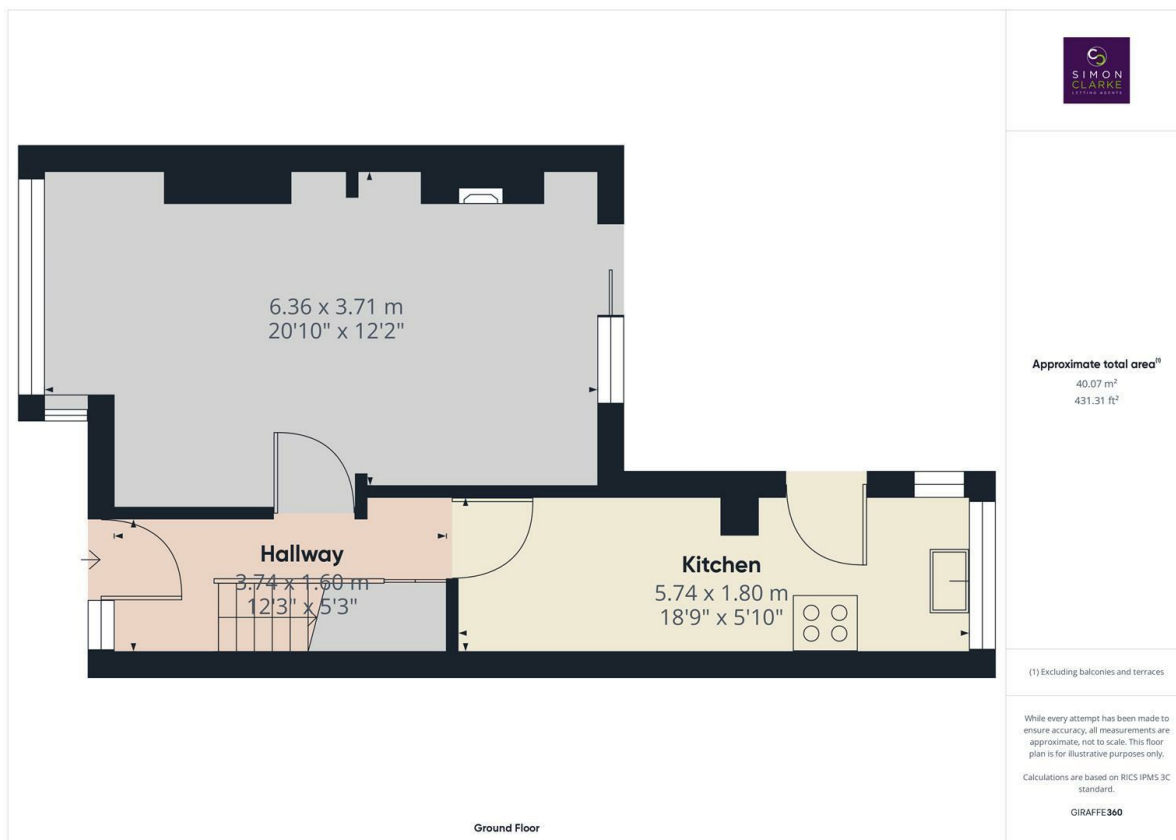

## Directions

7 Ballards Lane, Finchley, London, N3 1UX  
02083499000

## Viewings

Viewings by arrangement only. Call 02083499000 to make an appointment.

## Council Tax Band

D

## EPC Rating:

D

Energy Efficiency Rating		
	Current	Potential
Very energy efficient - lower running costs		
(92 plus) <b>A</b>		
(81-91) <b>B</b>		
(69-80) <b>C</b>		79
(55-68) <b>D</b>	62	
(39-54) <b>E</b>		
(21-38) <b>F</b>		
(1-20) <b>G</b>		
Not energy efficient - higher running costs		
<b>England &amp; Wales</b>	EU Directive 2002/91/EC	

Hello@simonclarke.co.uk  
www.simonclarke.co.uk