

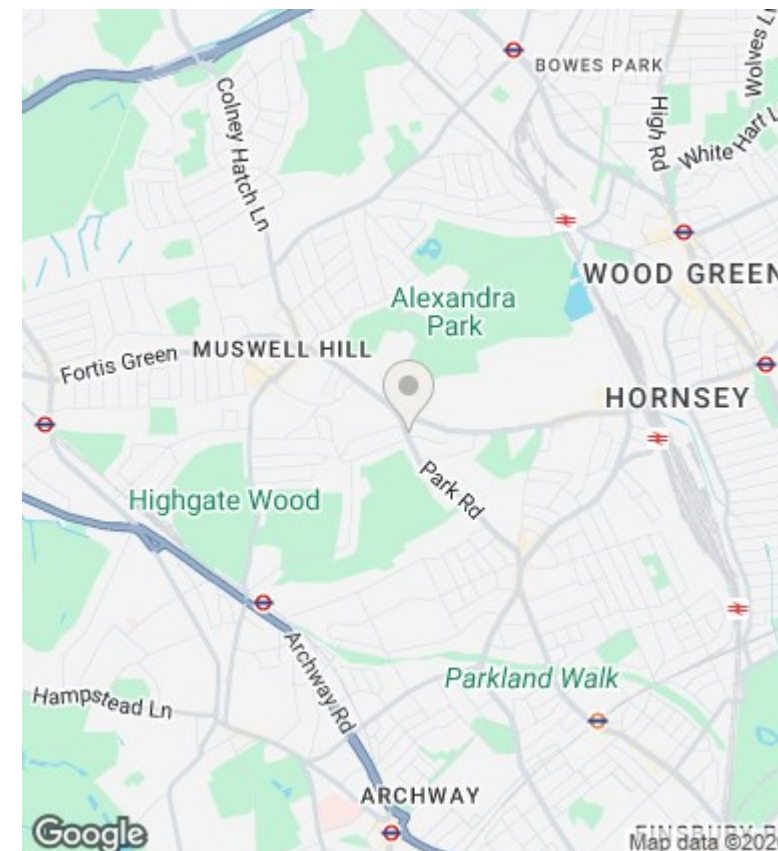

Park Road, London, N8 8LA

£1,750 PCM

- Second floor 2 bedroom flat above commercial premises
- Close to Priory Park, Muswell Hill and Crouch End vast array of shops and amenities
- Council tax band C - £1,962.61pa
- ***Not suitable for sharers***
- Fitted kitchen with appliances
- Fitted blinds throughout
- Unfurnished
- Built in wardrobes to both bedrooms
- Available on long term tenancy
- Available from 2nd February 2026

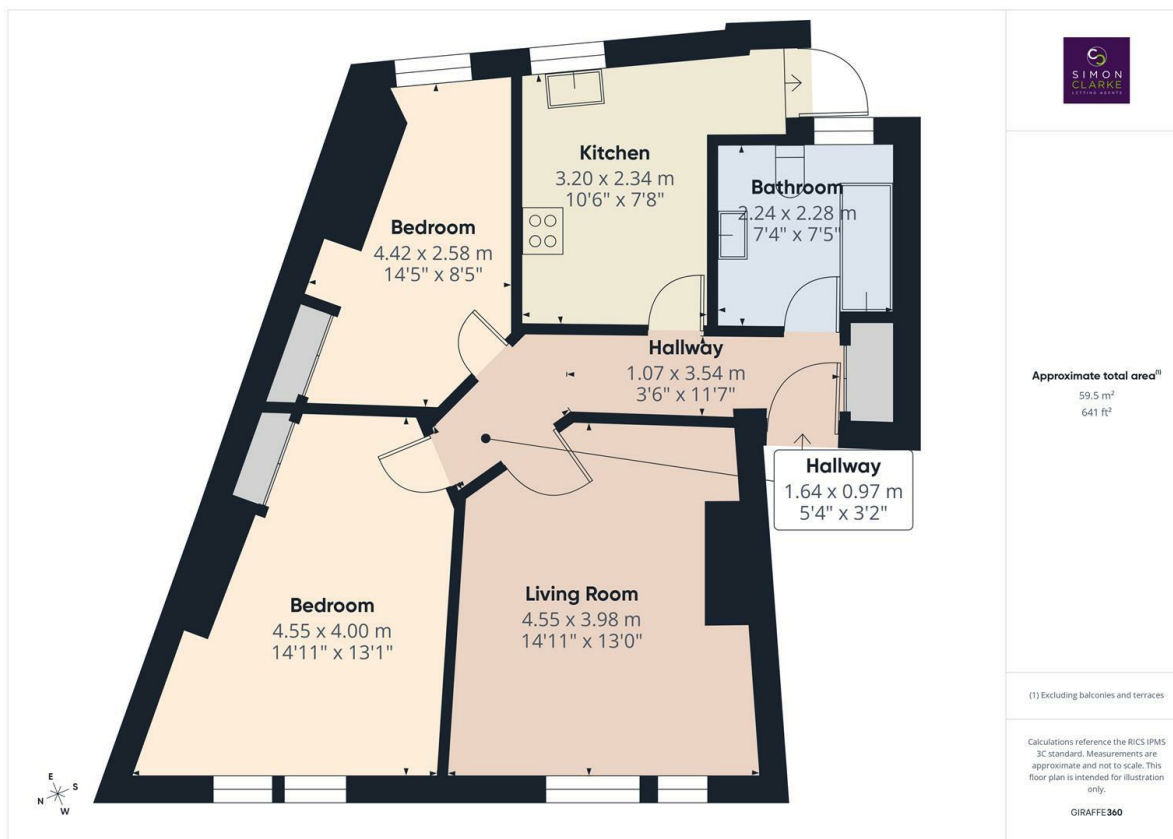

Directions

Viewings

Viewings by arrangement only. Call 02083499000 to make an appointment.

Council Tax Band

C

EPC Rating:

D

| Energy Efficiency Rating | | |
|---|-------------------------|-----------|
| | Current | Potential |
| Very energy efficient - lower running costs | | |
| (92-plus) A | | |
| (81-91) B | | |
| (69-80) C | | |
| (55-68) D | 60 | 66 |
| (39-54) E | | |
| (21-38) F | | |
| (1-20) G | | |
| Not energy efficient - higher running costs | | |
| England & Wales | EU Directive 2002/91/EC | |