

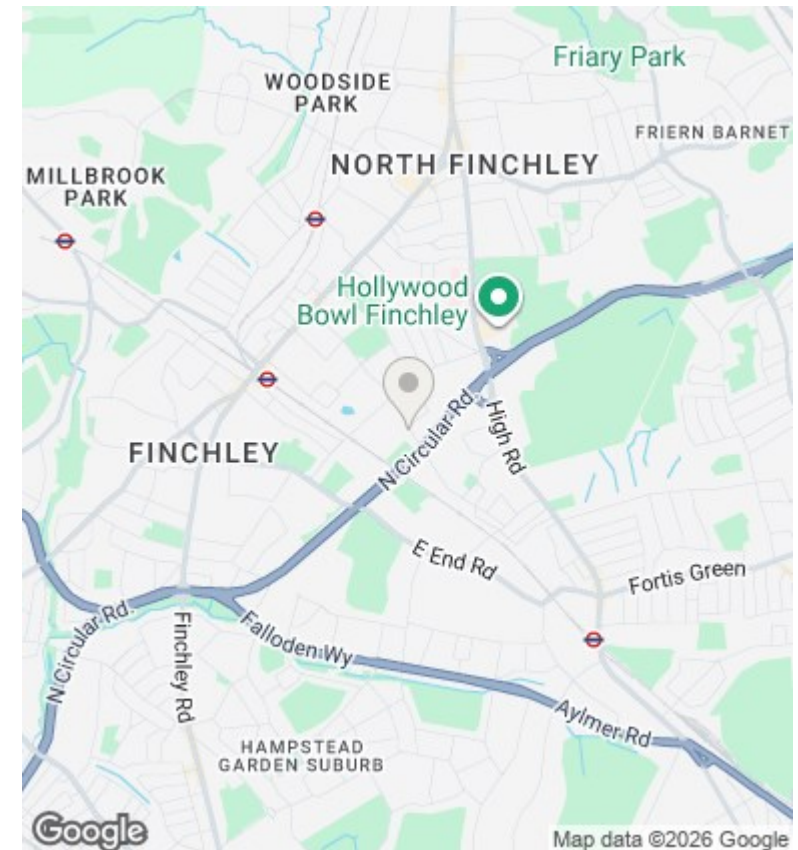

Long Lane, London, N3 2RN

£1,400 PCM

- First Floor 1 bedroom converted flat
- Fitted carpets throughout
- Available on long term tenancy (initial 12 months)
- Available from 7th February 2026
- Bright and spacious living room with feature bay
- Modern bathroom suite
- Council tax band C - £1,809.34pa
- Fitted wardrobes in double bedroom
- Fitted kitchen with appliances
- Unfurnished / part furnished

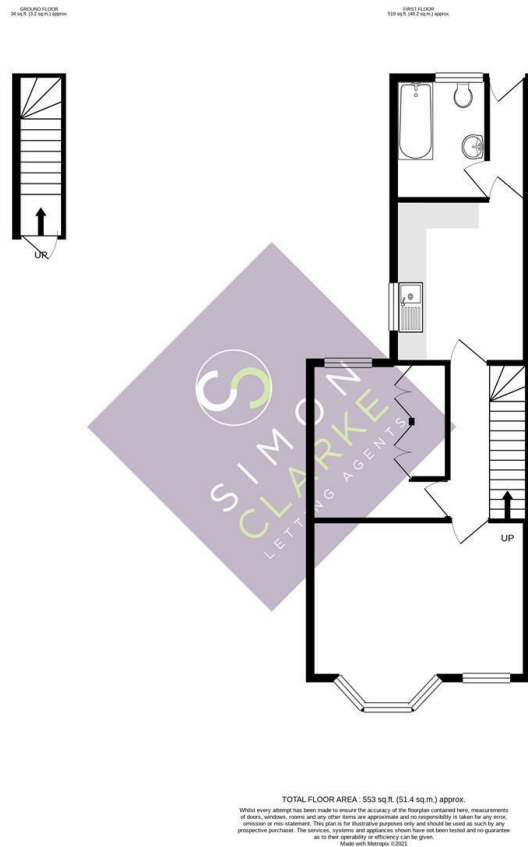

Directions

Viewings

Viewings by arrangement only. Call 02083499000 to make an appointment.

Council Tax Band

C

EPC Rating:

D

Energy Efficiency Rating		
	Current	Potential
Very energy efficient - lower running costs		
(92 plus) A		
(81-91) B		
(69-80) C		
(55-68) D	65	77
(39-54) E		
(21-38) F		
(1-20) G		
Not energy efficient - higher running costs		
England & Wales		EU Directive 2002/91/EC