

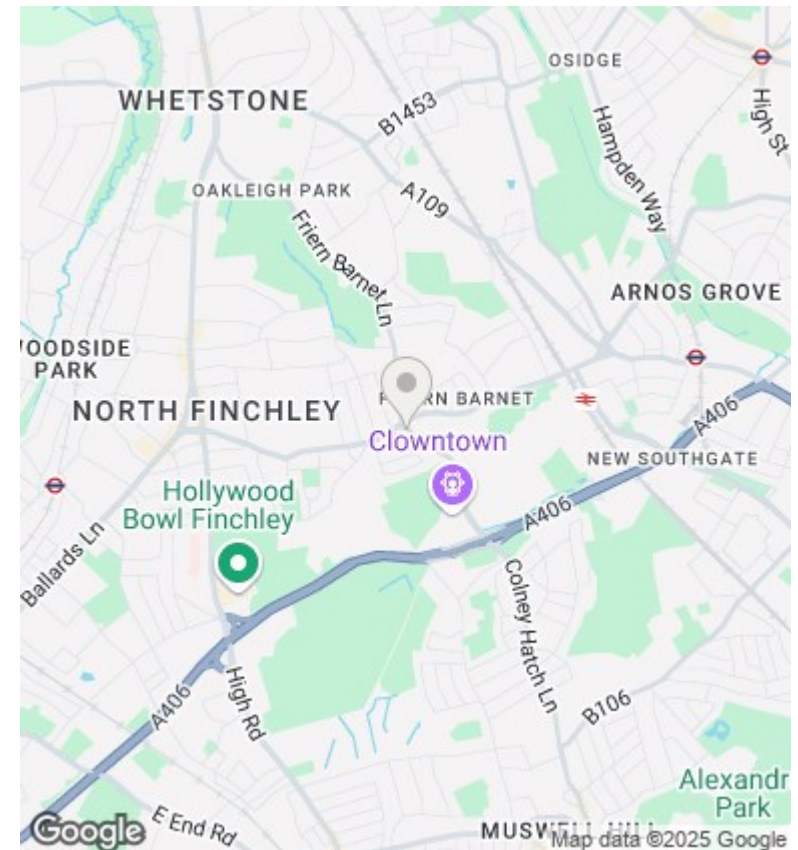

Woodhouse Road, London, N12 0ND

£1,600 Per Calendar Month

- 2 Bedroom 1st floor apartment
- Single bedroom with fitted wardrobe
- Available on long term tenancy (initial 12 months)
- Available now
- Brand new fitted kitchen
- Double bedroom with new laminate floor
- Unfurnished
- Part tiled bathroom
- Spacious lounge
- Council tax band C - £1,727.32pa

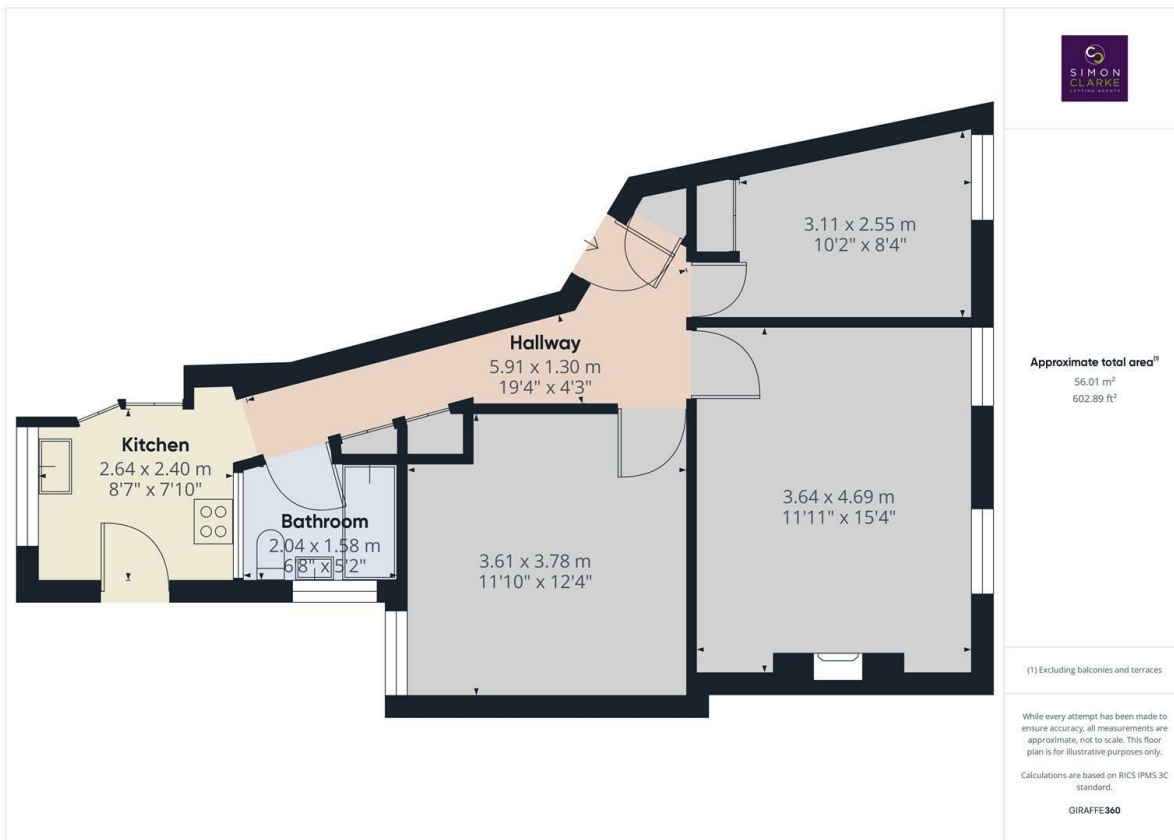

Directions

Viewings

Viewings by arrangement only. Call 02083499000 to make an appointment.

Council Tax Band

C

EPC Rating:

D

Energy Efficiency Rating		Current	Potential
<i>Very energy efficient - lower running costs</i>			
(92 plus) A			
(81-91) B			
(69-80) C			
(55-68) D		68	72
(39-54) E			
(21-38) F			
(1-20) G			
<i>Not energy efficient - higher running costs</i>			
England & Wales		EU Directive 2002/91/EC	